

WARM WELCOME  
TO THE NEW  
GREEN WORLD

**Landmark**  
— **Village**

**TOWER - 4**

K-RERA Registration Number : K-RERA/PRJ/214/2020



# THE FIRST AND THE BIGGEST GREEN TOWNSHIP IN SOUTH INDIA

Landmark Village @ Markaz Knowledge City  
It is unique and first of its kind in God's Own Country

An aerial photograph of a university campus. In the foreground, a large, modern building with a prominent yellow, ribbed dome is visible. To its right, a tall, multi-story building with a curved facade is under construction. The campus is surrounded by lush green trees and a road. In the background, a large, ornate building with multiple domes and minarets, resembling a mosque, stands out. Further back, several high-rise apartment buildings are visible against a backdrop of misty, forested hills.

**YOU ARE  
NOW AT AN  
AWESOME  
PLACE**

# Markaz Knowledge City

The Green Capital of Knowledge and Fine Living  
125 Acre of lush green landscape  
Integrated Township  
Global Destination For Research And Development  
Abode Of Fine Living And Leisure

The key Components

**EDUCATION**

**HEALTH**

**HOSPITALITY**

**CULTURE**

**COMMERCE**

**FINE LIVING**

**CAREER**

## EDUCATION

The Dynamic Abode of Knowledge & Innovation

- Unani Medical College
- Law College
- WIRAS
- Alif Global School
- Queens Land
- Business School
- Agriculture College
- Centre for excellence  
(Robotics/ Multi-media / Artificial Intelligence)
- HILLSSINAI Finishing School
- Malaibar Institute
- Habitus The Life School
- Meem Acadamia
- Pharmacy College
- Special Need School



## Residential & Fine Living

Landmark Village  
The only and exclusive residential zone  
in Markaz Knowledge City



We are building  
South India's  
BIGGEST  
Green  
Township

6 Marvellous Towers  
Lush Green Landscape  
The fascinating Location  
The Mesmerising Valley of Western Ghats  
Spacious Living Spaces  
Mind-blowing Facilities

# WHY WE ARE DIFFERENT

## It is a Unique and Unparalleled Project

20 acre of Land | 6 Towers | 4 Residential Towers | 2 Commercial cum Residential Towers | 40:60 Construction | Sky Villa Concept | Villaments Duplexes | Club House in 1.5acre land | 30mtr Wide Internal Roads | 40+ Amenities | Office Spaces | Education Spaces

This is the best place to Live, Learn, and Leisure. We guarantee elegance at each points.

40+ amenities to ensure your heavenly joy.

Jogging & cycle track | Children's park,  
Herbal & fruit garden | Roof-top party area



# CLUB 99

Club 99 is an enthralling space brimming with opulence. Spread across 1.5 acres of lush greenery and stood elegantly amidst six skyscrapers, Club 99 serves as the head and heart of Landmark Village. An architectural marvel in 32,000sq.ft, it is one of the biggest club house in South India providing world-class facilities and unforgettable experience.

The exciting amenities awaiting you at Club 99;

Grand Entry Lobby | Half Olympic Pool | Exclusive Swimming Pool for Ladies | Multipurpose Hall-250pax | Launch- Gents and Ladies | Gymnasium- Gents & Ladies | Meditation Centre | Suite Rooms | Prayer Hall | Kids Day Care | Children Play Area | Football Court | Basketball Court | Badminton Court | Poolside Party Area

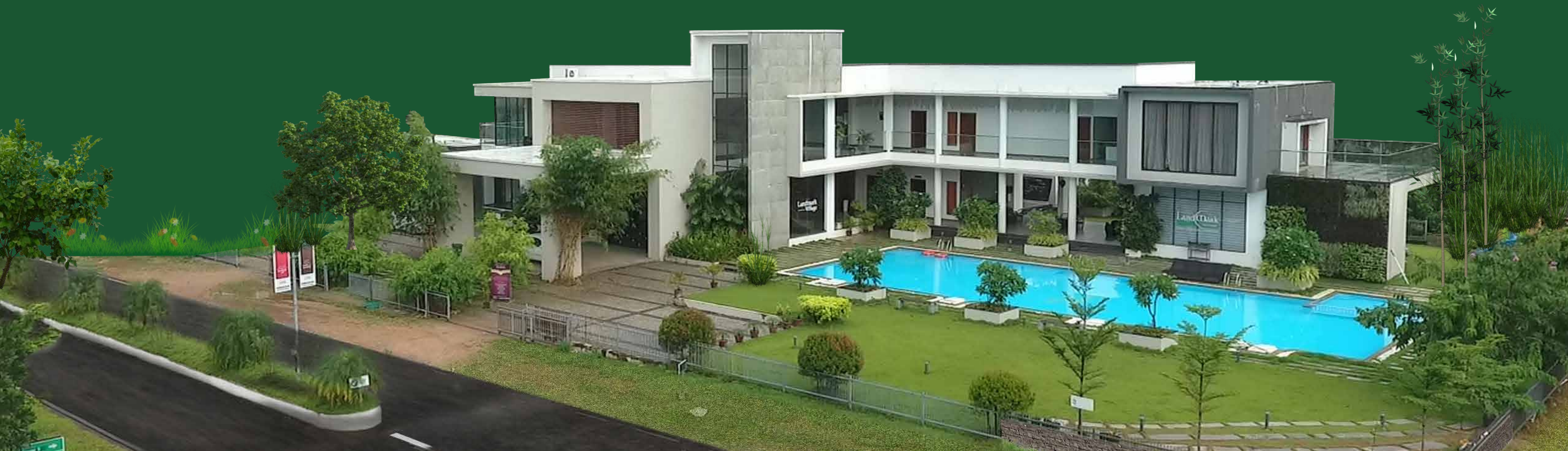

## TOWER - 2

# THE PLACE YOU DESIRED TO MEET

Tower 02

Floor Height : 20 floors

Apartments : 2BHK (1040 sq.ft & 1228 sq.ft),  
3BHK (1426 sq.ft & 1587 sq.ft),

Villaments : 2BHK



Please Scan Here  
for Available Units and Plans

K-RERA Registration Number : K-RERA/PRJ/222/2020

READY TO MOVE



# TOWER - 2

GROUND FLOOR

- GH - 3 BHK

1501 + 749 Sqft
- GE - 3 BHK

1501 + 1124 Sqft



- GA - 3 BHK

1663 + 1098 Sqft
- GD - 3 BHK

1663 + 1584 Sqft

TOWER - 2  
GROUND FIRST FLOOR

- GFH - 3 BHK  
1426 + 161 Sqft
- GFG - 2 BHK  
1040 + 595 Sqft
- GFF - 2 BHK  
1040 + 595 Sqft
- GFE - 3 BHK  
1426 + 161 Sqft

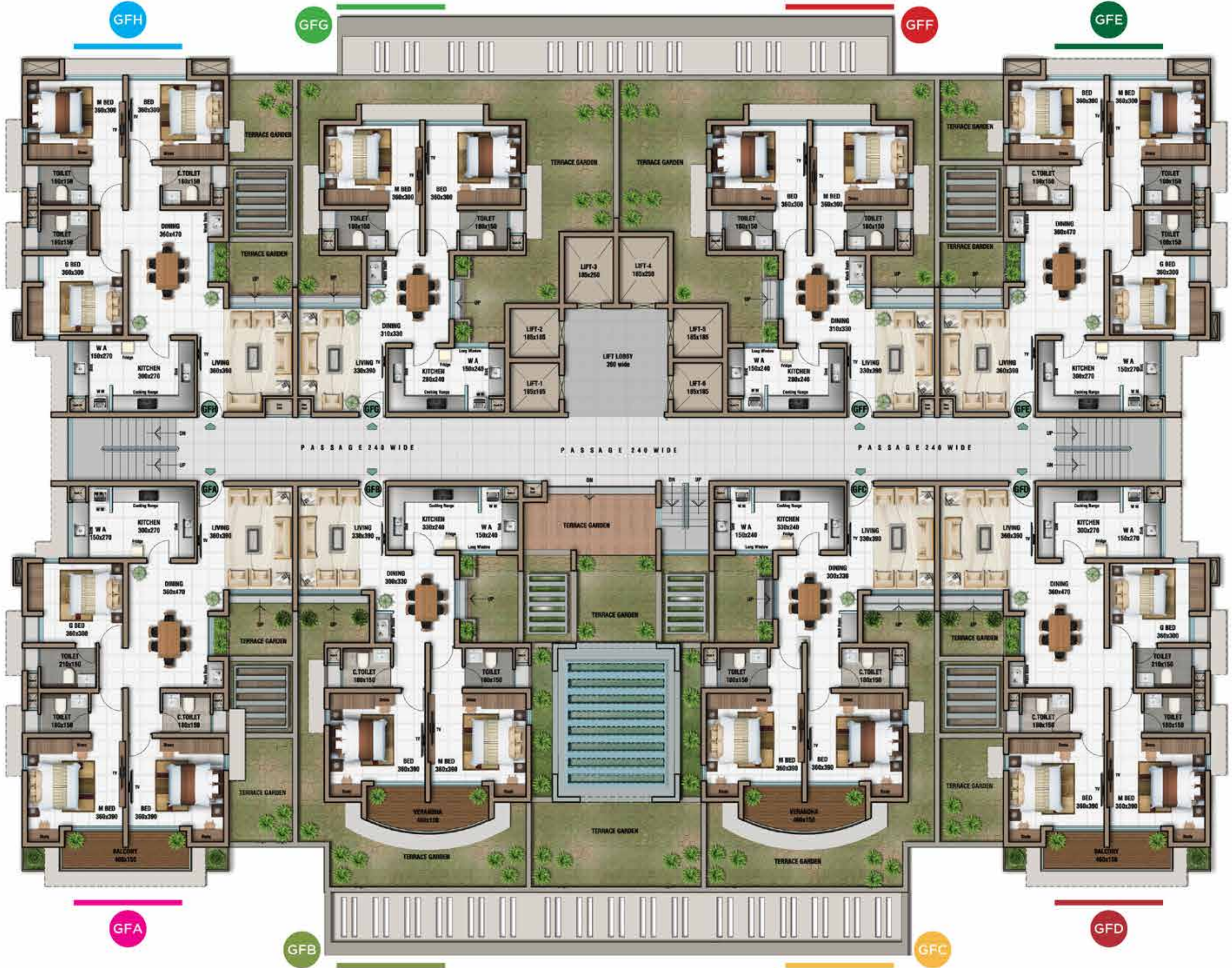

- GFA - 3 BHK  
1587 + 749 Sqft
- GFB - 2 BHK  
1228 + 465 Sqft
- GFC - 2 BHK  
1228 + 465 Sqft
- GFD - 3 BHK  
1587 + 213 Sqft

**TOWER - 2**  
TYPICAL FLOOR PLAN  
(1st TO 18th)

- H - 3 BHK**  
1426 Sqft
- G - 2 BHK**  
1040 Sqft
- F - 2 BHK**  
1040 Sqft
- E - 3 BHK**  
1426 Sqft

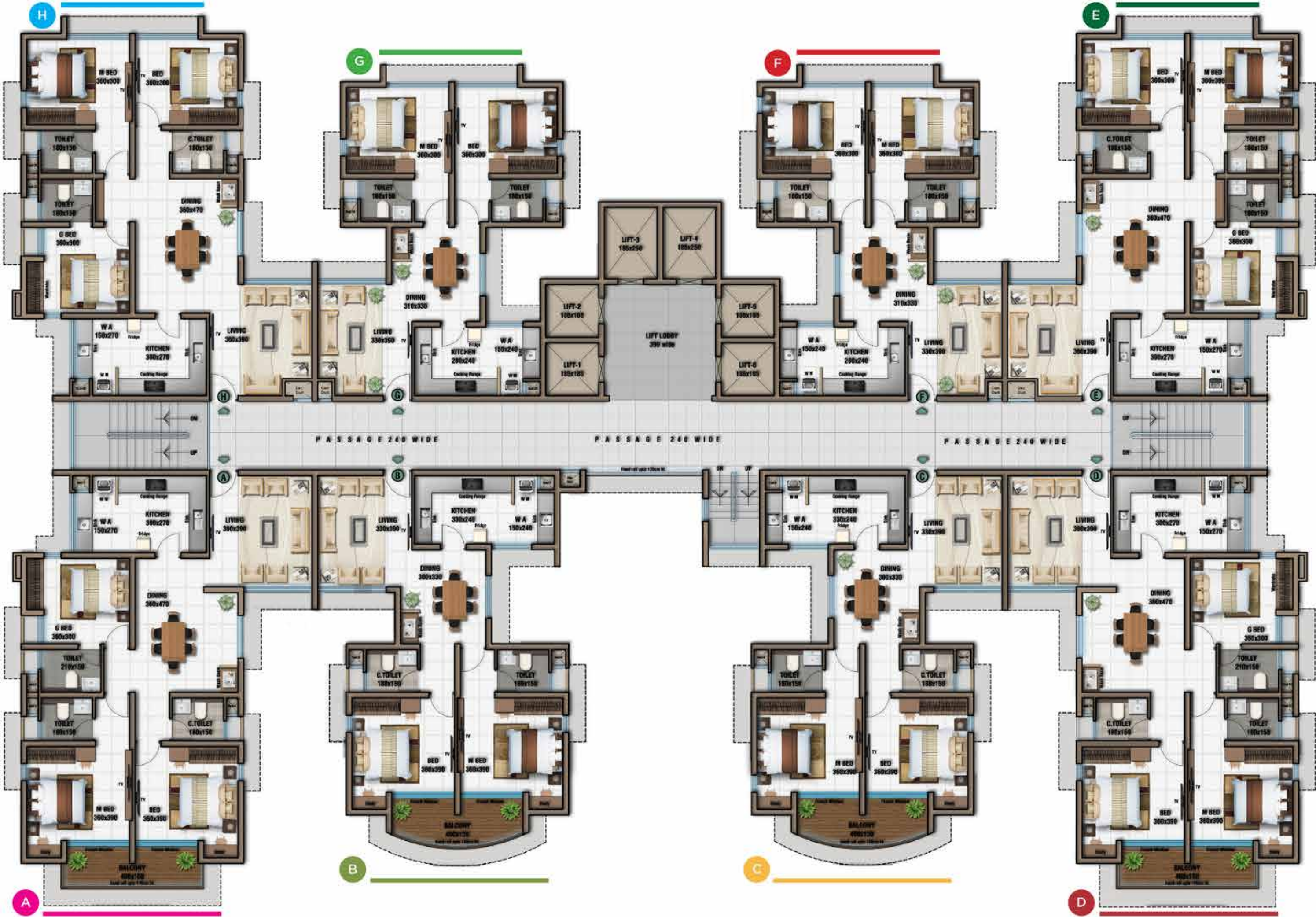

- A - 3 BHK**  
1587 Sqft
- B - 2 BHK**  
1228 Sqft
- C - 2 BHK**  
1228 Sqft
- D - 3 BHK**  
1587 Sqft

TOWER - 3



# THE MAGNIFICENT ABODE OF SHEER LUXURY

Tower 03

Floor Height : 20 floors

Apartments : 2BHK (1058 sq.ft to 1644 sq.ft )  
3BHK (1993 sq.ft )

Villaments : 2BHK, 3BHK



Please Scan Here  
for Available Units and Plans

K-RERA Registration Number : K-RERA/PRJ/221/2020

TOWER - 3  
GROUND FLOOR

- GH - 2 BHK  
1992 + 711 Sqft
- GE - 3 BHK  
1992 + 780 Sqft



- GA - 3 BHK  
2137 + 1627 Sqft
- GD - 3 BHK  
2137 + 1732 Sqft

**TOWER - 3**  
GROUND FIRST FLOOR

- GFH - 2 BHK**  
1324 + 596 Sqft
- GFG - 2 BHK**  
1058 + 375 Sqft
- GFF - 2 BHK**  
1058 + 167 Sqft
- GFE - 2 BHK**  
1324 + 596 Sqft



- GFA - 3 BHK**  
1941 + 132 Sqft
- GFB - 2 BHK**  
1647 + 435 Sqft
- GFC - 2 BHK**  
1647 + 435 Sqft
- GFD - 3 BHK**  
1941 + 132 Sqft

# TOWER - 3

TYPICAL FLOOR PLAN  
(1st TO 18th)

- H - 2 BHK  
1199 Sqft
- G - 2 BHK  
1058 Sqft
- F - 2 BHK  
1058 Sqft
- E - 2 BHK  
1199 Sqft

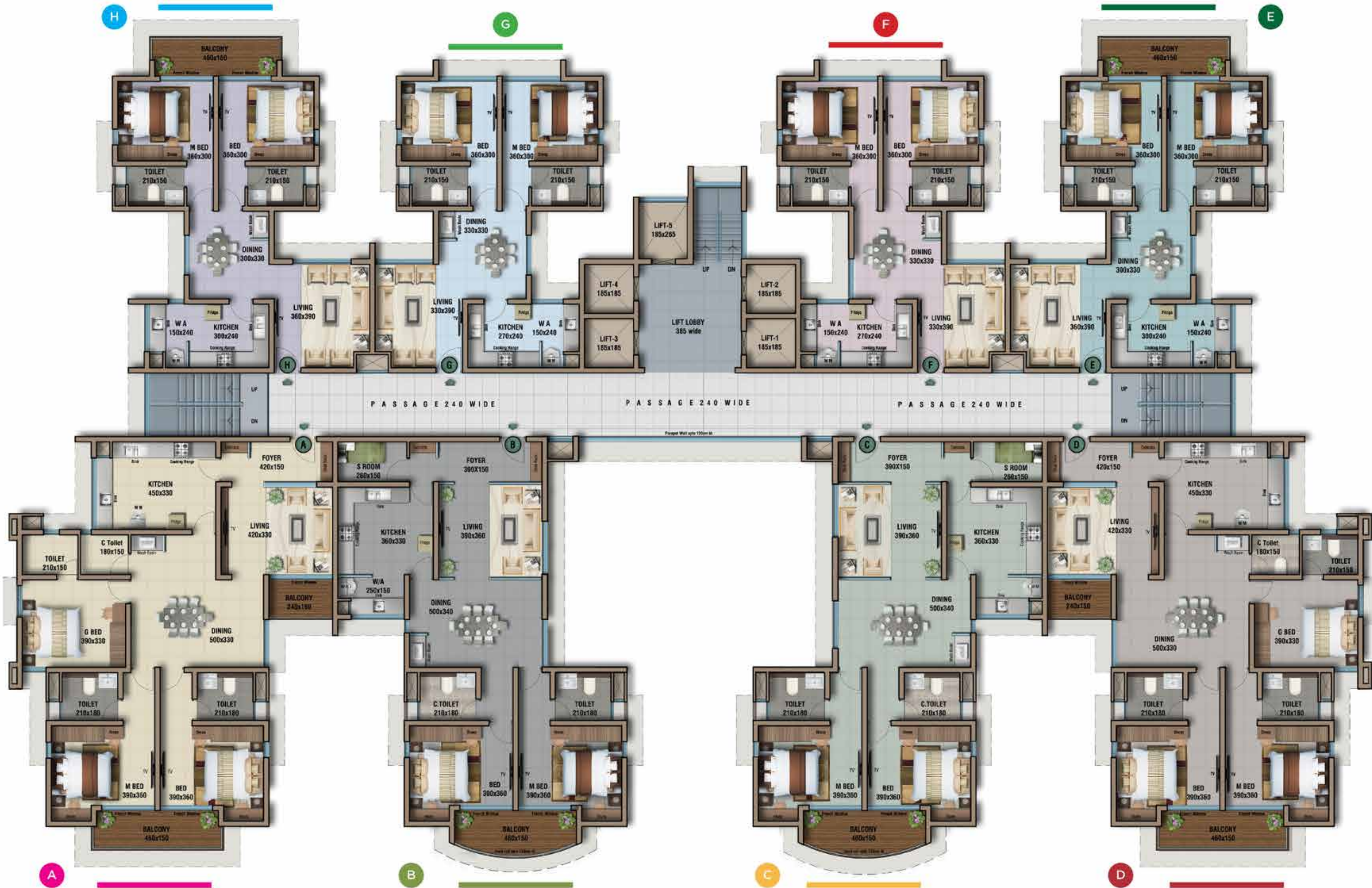

- A - 3 BHK  
1993 Sqft
- B - 2 BHK  
1644 Sqft
- C - 2 BHK  
1644 Sqft
- D - 3 BHK  
1993 Sqft

## TOWER - 4

# AN IDEAL HOME FOR YOUR LIFE

Tower 04

Floor Height : 20 floors

Apartments : 2BHK ( 963 sq.ft to 1070 sq.ft )

Villaments : 2BHK



Please Scan Here  
for Available Units and Plans

K-RERA Registration Number : K-RERA/PRJ/214/2020



## GROUND FLOOR PLAN

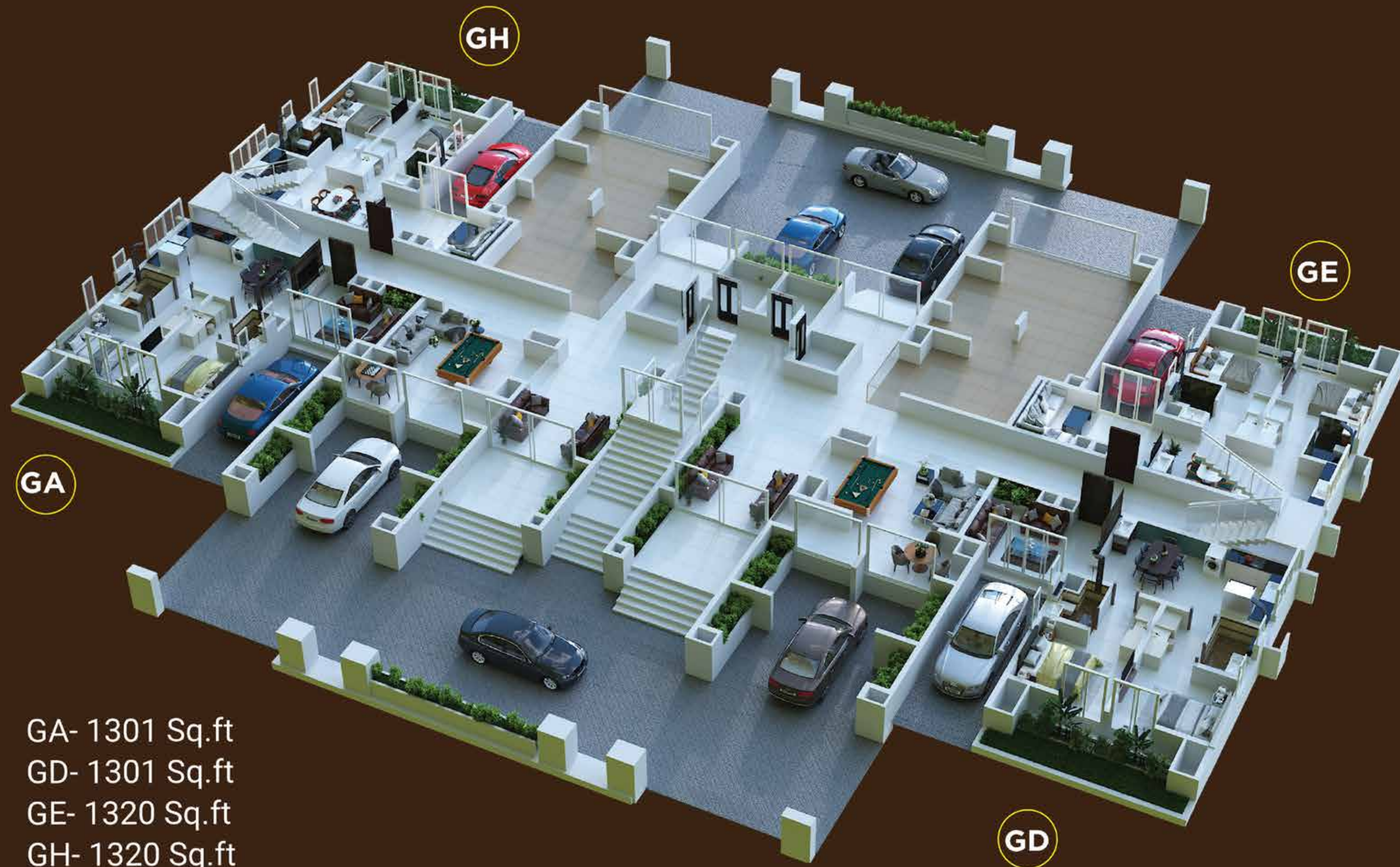

GA- 1301 Sq.ft  
GD- 1301 Sq.ft  
GE- 1320 Sq.ft  
GH- 1320 Sq.ft

## FIRST FLOOR PLAN

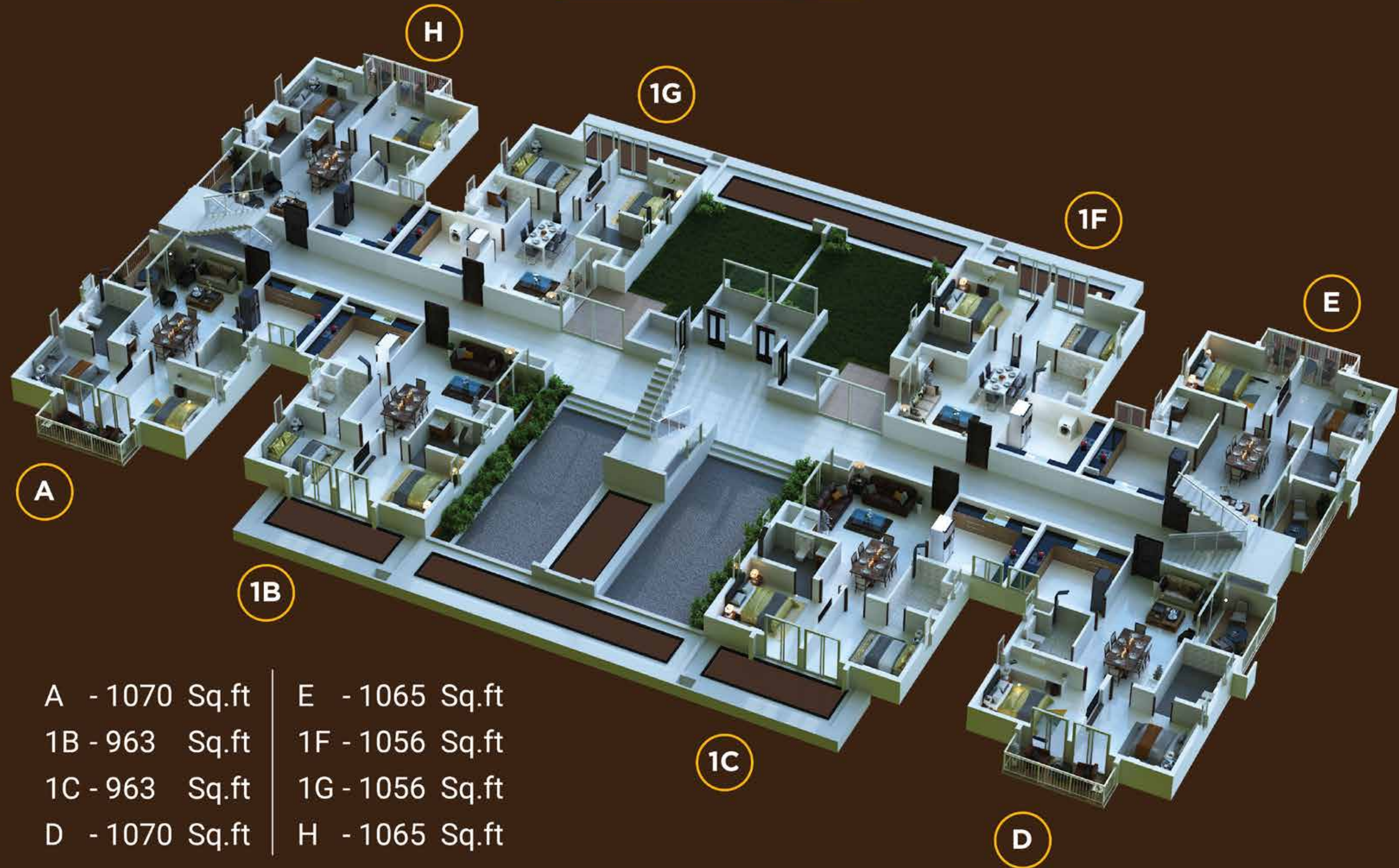

## TYPICAL FLOOR PLAN

2<sup>nd</sup> Floor To 19<sup>th</sup> Floor

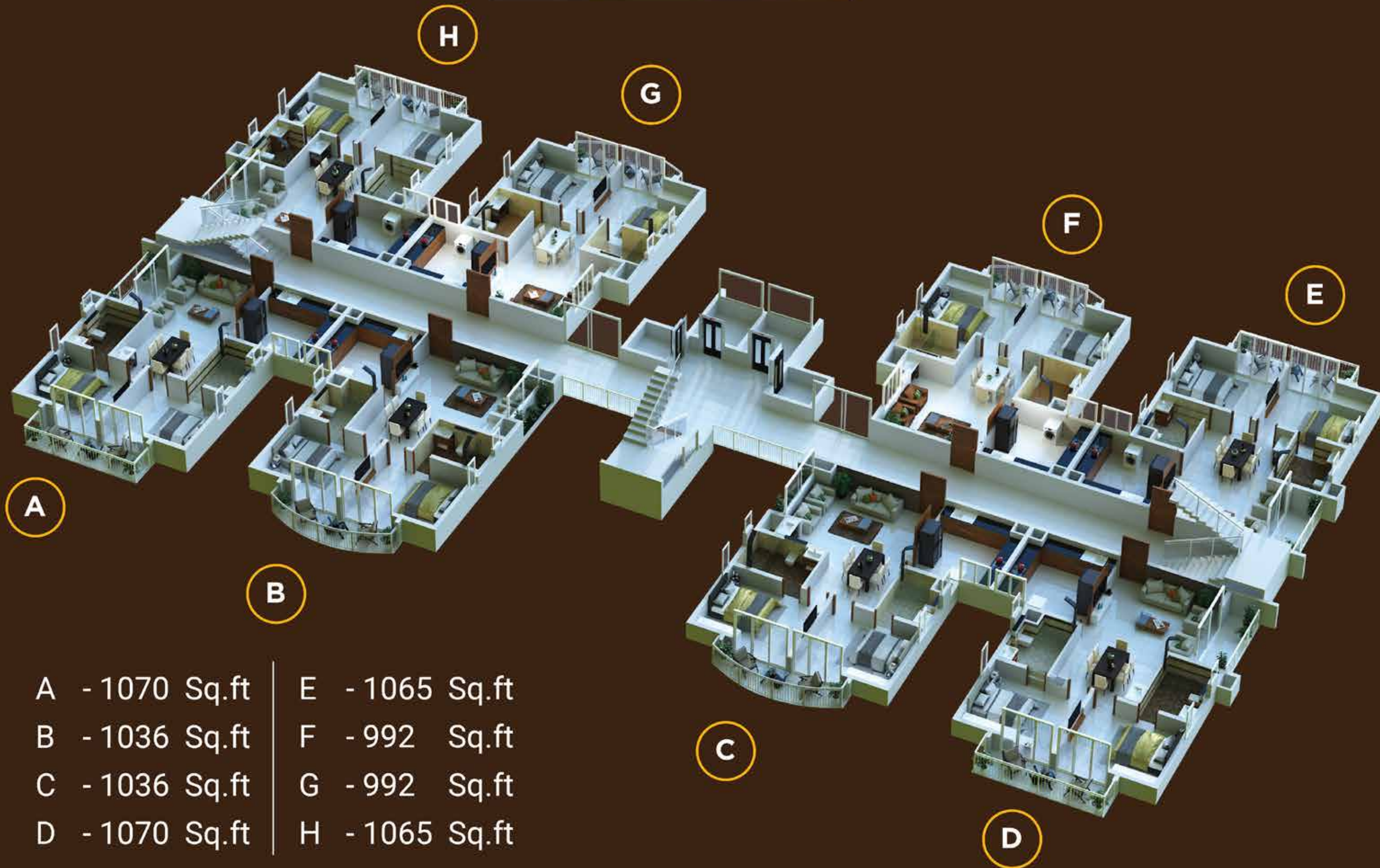

TOWER - 6,7

# THE SKYSCRAPER OF SEAMLESS JOY

Tower 07

Floor Height : 20 floors

Apartments : 1BHK ( 600 sq.ft to 737sq.ft )

Office and Education space

: 300sq.ft to 3038sq.ft



Please Scan Here  
for Available Units and Plans

K-RERA Registration Number : K-RERA/PRJ/231/2020



TOWER - 7  
TYPICAL FLOOR PLAN  
(5th TO 19th)



- F1 - STUDIO  
465 Sqft
- E1 - STUDIO  
424 Sqft
- K - 1 BHK  
708 Sqft
- H4 - 1 BHK  
630 Sqft
- H3 - 1 BHK  
630 Sqft
- J4 - 2 BHK  
600 Sqft
- J3 - 1 BHK  
600 Sqft
- J2 - 1 BHK  
600 Sqft
- J1 - 1 BHK  
600 Sqft
- H2 - 1 BHK  
630 Sqft
- H1 - 1 BHK  
630 Sqft
- G - 1 BHK  
710 Sqft

- F - STUDIO  
465 Sqft
- E - STUDIO  
424 Sqft
- D - 1 BHK  
731 Sqft
- B4 - 1 BHK  
726 Sqft
- B3 - 1 BHK  
726 Sqft
- C4 - 1 BHK  
691 Sqft
- C3 - 1 BHK  
691 Sqft
- C2 - 1 BHK  
691 Sqft
- C1 - 1 BHK  
691 Sqft
- B2 - 1 BHK  
726 Sqft
- B1 - 1 BHK  
726 Sqft
- A - 1 BHK  
737 Sqft

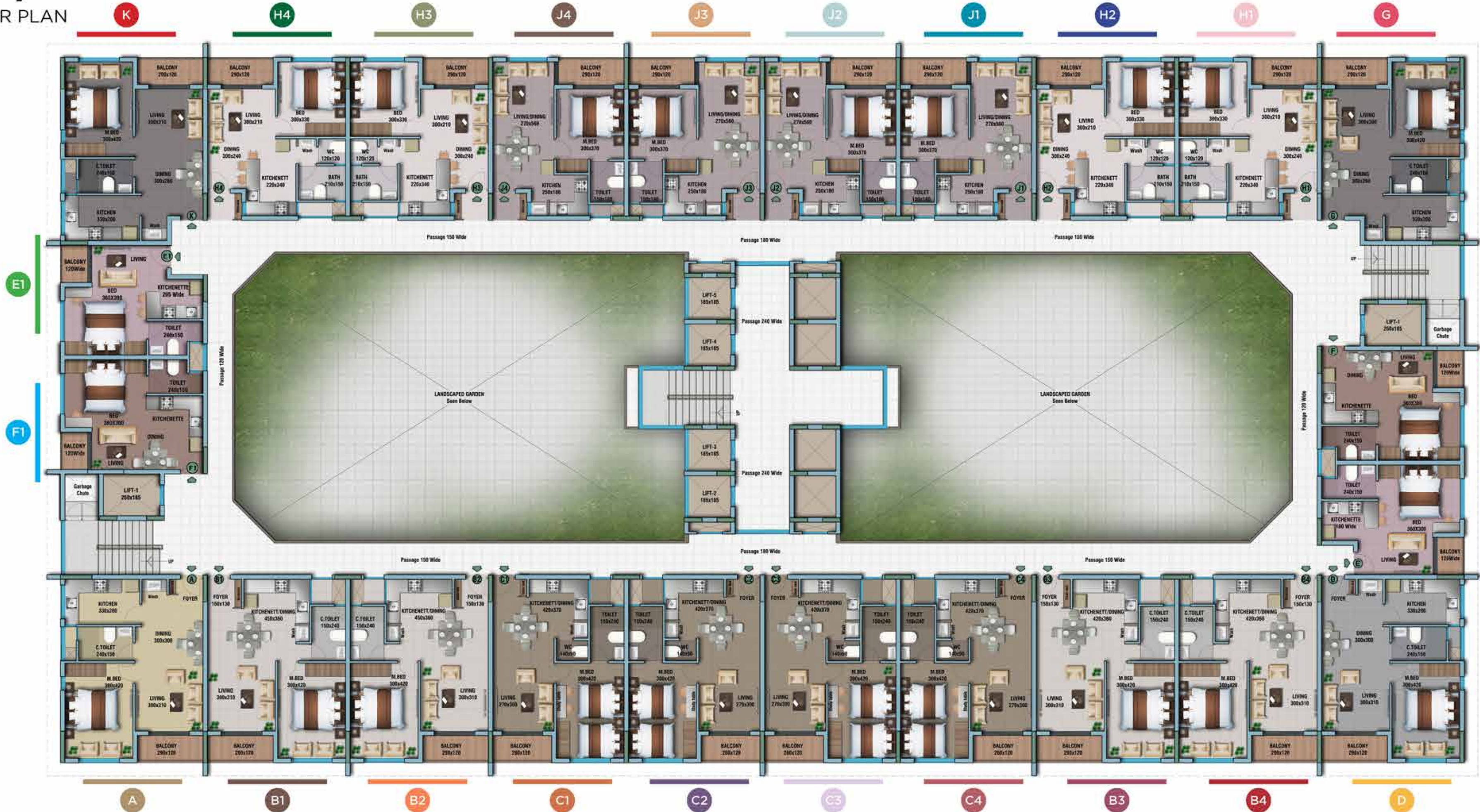



# YOU HAVE MANY REASONS TO INVEST HERE

Being the CITIZEN of MKC  
Ownership of the Apartment  
To be part of a great project in history  
100% Setcurity  
An Architectural treasure for your beloved ones  
100% Value appreciation

# WHY YOU CAN TRUST UPON **LANDMARK**

Every step we have taken has not just left an impression  
It has an impact with unique landmark.

## OUR STORY OF SUCCESS

15+ Years

10+ Projects Completed

16+ Projects Under Construction

2000+ Trusted Investors and Satisfied Families

15,00,000 sq.ft Delivered with Excellence

30,00,000 sq.ft Under Construction



NOW EMBRACE THE PEAK WITH PASSION  
IT IS THE RIGHT  
TIME TO CHOOSE  
**A PROMISING  
FUTURE**

WAY TO  
EVERY  
WHERE



The depictions shown in the brochure are purely representative in nature. The actual product may vary. Please go through the specifications mentioned in the brochure for actual product information



Landmark  
— Village



Landmark Village, Markaz Knowledge City,  
Kannoth (PO) Kozhikkode, Kerala-India 673 580

🌐 [www.landmarkvillage.in](http://www.landmarkvillage.in), 📧 [info@landmarkvillage.in](mailto:info@landmarkvillage.in)  
📱 [landmarkvillage](#) 📞 +91 9388 353535

K-RERA Registration Number : K-RERA/PRJ/214/2020